

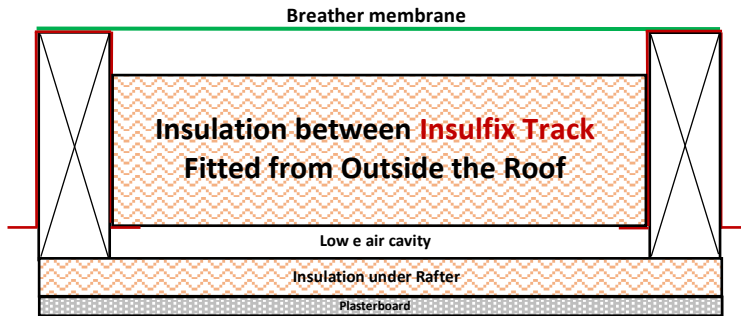

**Indicative U-values Insulfix Track  
Fitted from Outside the Roof  
150mm Rafters @ 400mm Centres**

12/4/21  
Version 1.0

Indicative U-values are based on the following typical construction:



**Indicative U-values: 100mm Insulation between Rafters**  
150mm Rafters @ 400mm Centres

Insulation between (0.022 W/m.K)	100mm	100mm	100mm	100mm	100mm
Insulation under (0.022 W/m.K)	None	25mm	30mm	40mm	50mm
Low e cavity air space?	✓	✓	✓	✓	✓
12.5mm Plasterboard?	✓	✓	✓	✓	✓
<b>Indicative U-value (W/m<sup>2</sup>K)</b>	<b>0.29</b>	<b>0.21</b>	<b>0.20</b>	<b>0.18</b>	<b>0.16</b>

**Indicative U-values: 110mm Insulation between Rafters**  
150mm Rafters @ 400mm Centres

Insulation between (0.022 W/m.K)	110mm	110mm	110mm	110mm	110mm
Insulation under (0.022 W/m.K)	None	25mm	30mm	40mm	50mm
Low e cavity air space?	✓	✓	✓	✓	✓
12.5mm Plasterboard?	✓	✓	✓	✓	✓
<b>Indicative U-value (W/m<sup>2</sup>K)</b>	<b>0.27</b>	<b>0.21</b>	<b>0.18</b>	<b>0.17</b>	<b>0.16</b>

**Indicative U-values: 120mm Insulation between Rafters**  
150mm Rafters @ 400mm Centres

Insulation between (0.022 W/m.K)	120mm	120mm	120mm	120mm	120mm
Insulation under (0.022 W/m.K)	None	25mm	30mm	40mm	50mm
Low e cavity air space?	✓	✓	✓	✓	✓
12.5mm Plasterboard?	✓	✓	✓	✓	✓
<b>Indicative U-value (W/m<sup>2</sup>K)</b>	<b>0.25</b>	<b>0.18</b>	<b>0.17</b>	<b>0.16</b>	<b>0.15</b>

**Please Note**

- These are indicative U-values only and must **not** be used for Building Control validation or for a SAP Assessment.
- We strongly recommend that both a **U-value Calculation** and a **Condensation Risk Analysis** are carried out on approved software by a suitably qualified technical representative.
- **Always check** with the manufacturer of the breather membrane for the **minimum gap** required between the insulation and the membrane

***This information is supplied in good faith but without liability. It is the responsibility of the building designer to ensure the construction complies with appropriate building regulations and standards.***